

Tyler } as 121  
 & } 41.. 115  
 Calkins }  
 \$ } 148.. 125  
 Total } 190.. 80

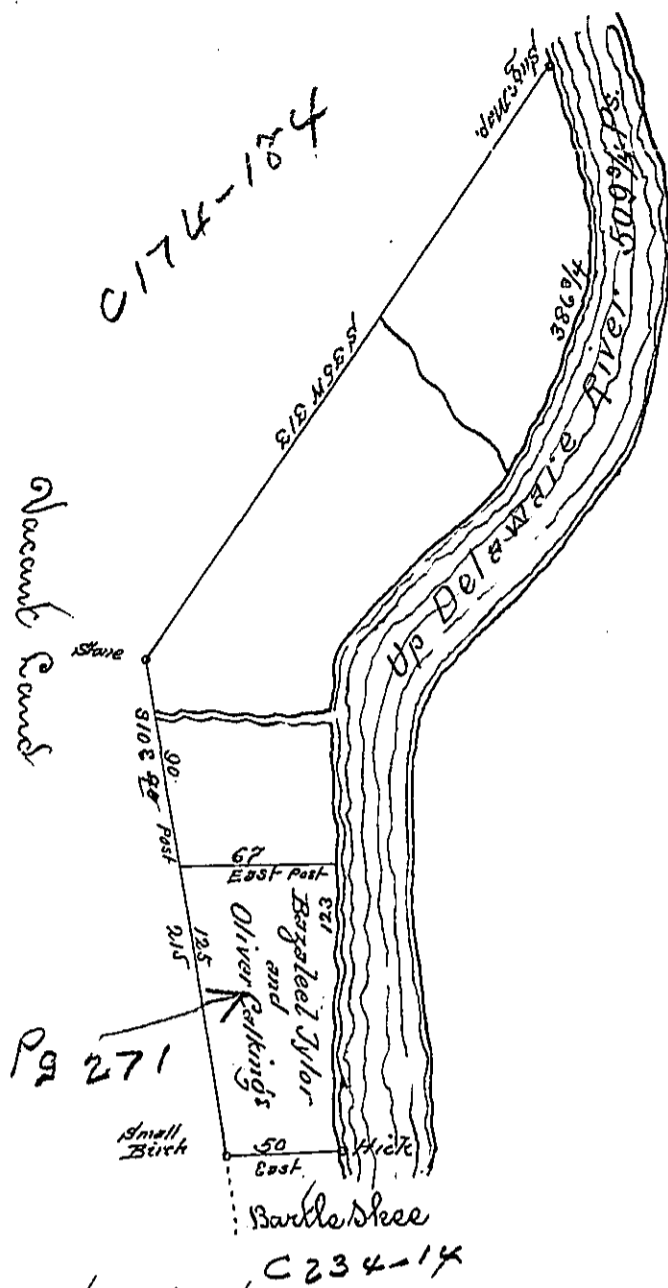

The bearing and distance up Delaware river are

1. North 91 3/4
2. N 27 E 21
3. N 48 E 94
4. N 28 E 46
5. N 10 E 66
6. N 11 W 50
7. N 19 W 18

By virtue of a Warrant dated the 6 Decem<sup>r</sup> 1774 and surveyed the 26 of Sep-  
 tem<sup>r</sup> 1775 to Josiah Parks the above described tract of land situate on a  
 brook called Topalut between Equinunk creek and Shawken in Northamp-  
 ton County containing an hundred & forty eight acres an hundred & twenty  
 five perches and the allowance of six & cent &c<sup>a</sup>

To John Lukens Esq<sup>r</sup> }  
 Surveyor General }

W. Geo Palmer W. S.

IN TESTIMONY that the above is a copy of the original remaining on file in the  
 Department of Internal Affairs of Pennsylvania, made con-  
 formably to an Act of Assembly approved the 16th day of  
 February, 1833. I have hereunto set my Hand and caused  
 the Seal of said Department to be affixed at Harrisburg, this  
 11th day of March 1896.

James W. Hatta  
 Secretary of Internal Affairs.